

PENINSULAR HOUSE

2ND FLOOR

11,502 SQ FT

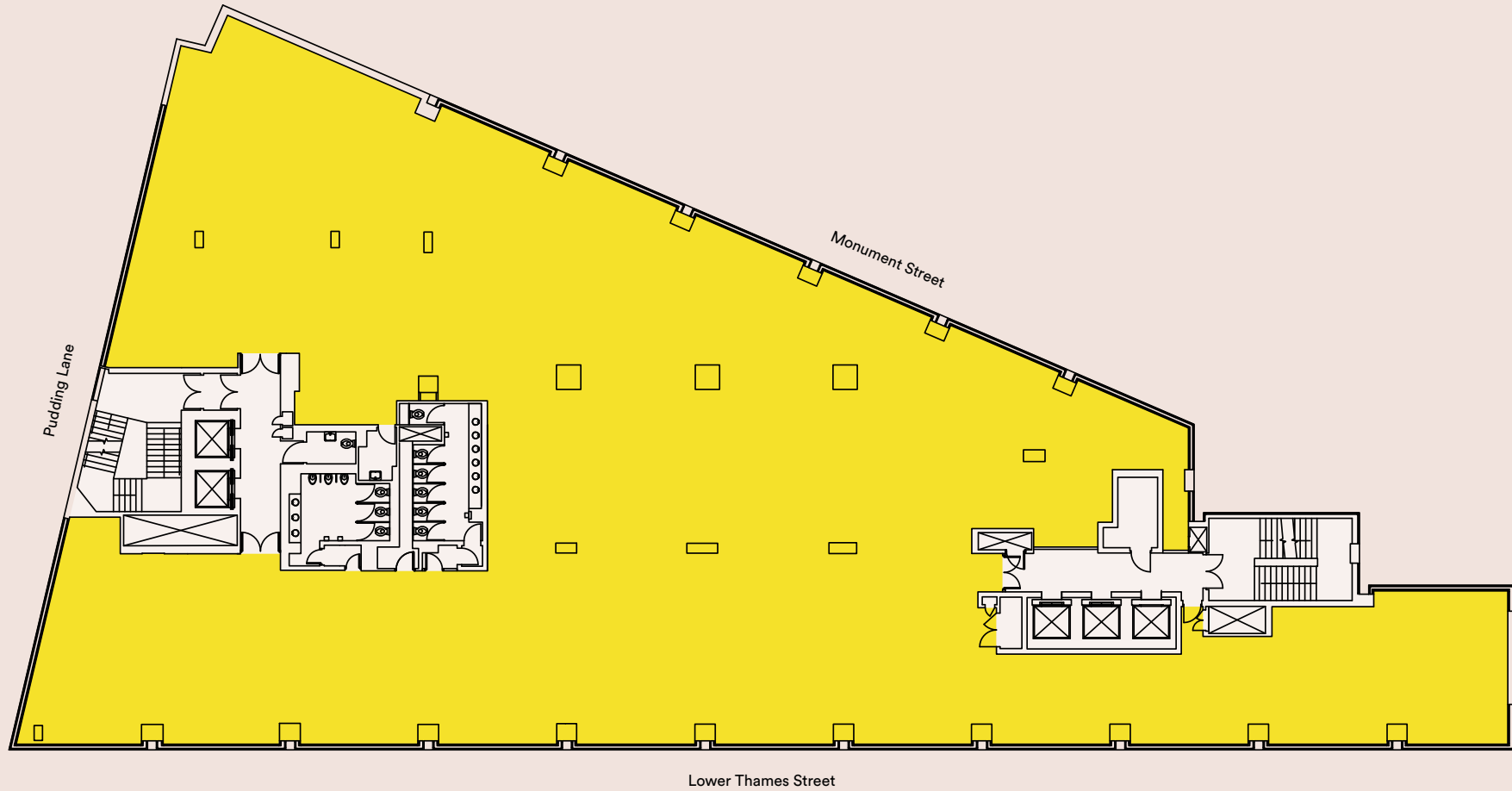

NORTH



Plan not to scale.
For indicative purposes only.

PENINSULAR HOUSE

6TH FLOOR

7,042 SQ FT

Open plan desks	60	12 person meeting room	01
Informal working areas	05	Teapoint	03
6 person meeting room	02	Reception	01
8 person meeting room	01	Comms Room	01

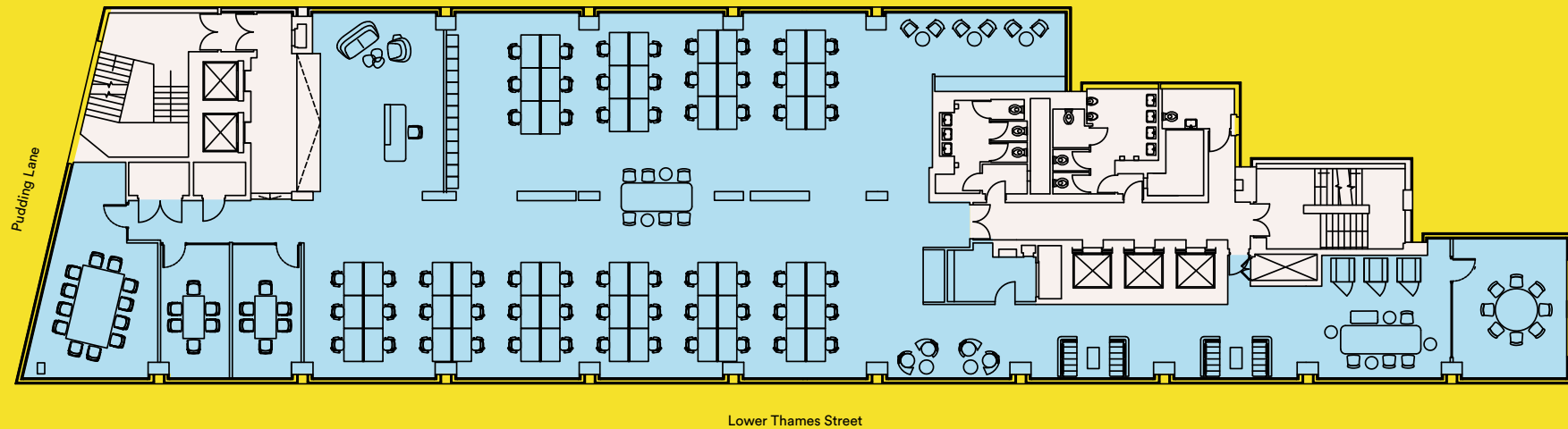

NORTH



Plan not to scale.
For indicative purposes only.